

CAPITHETICAL.
AUSTRALIAN CAPITAL CITY TOWARDS
ANGELOPOLIS

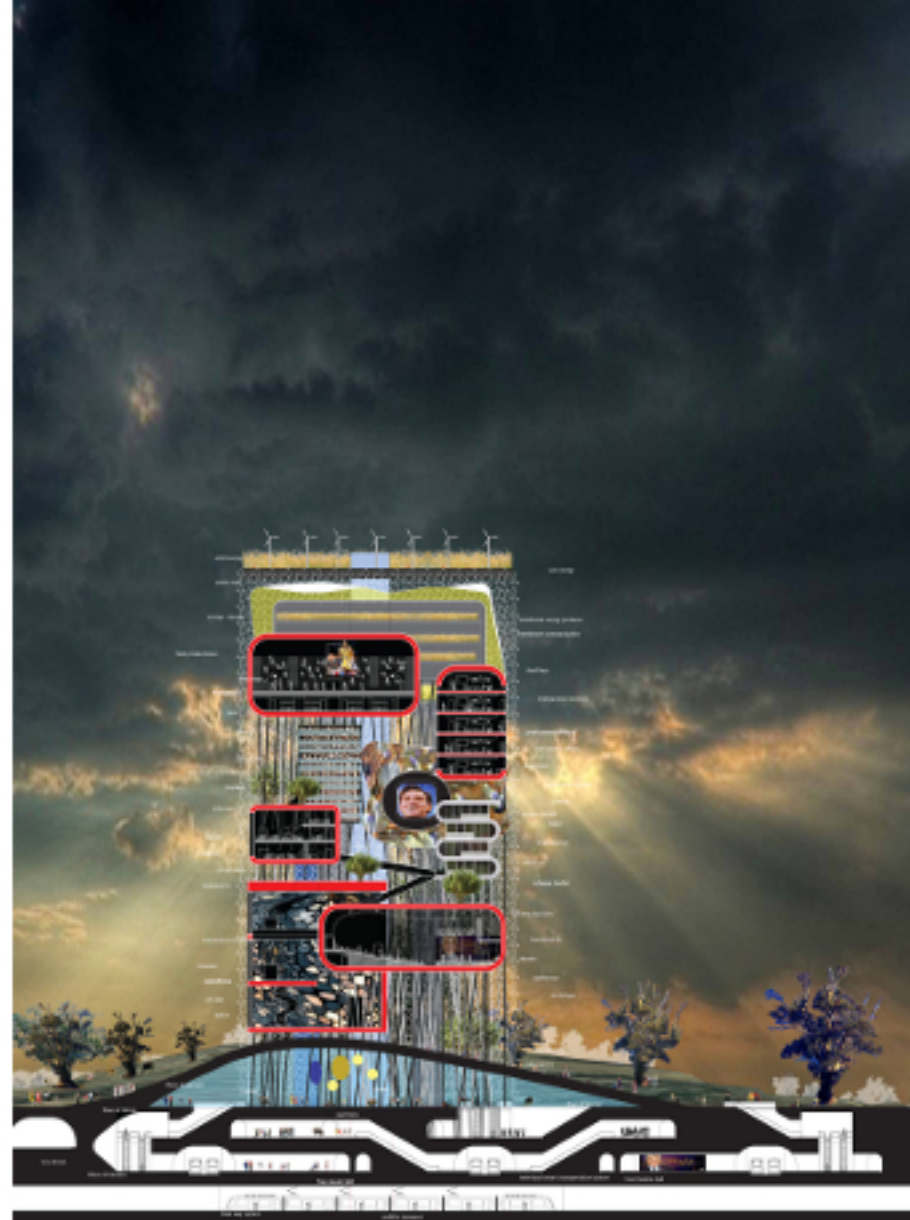





PHILOSOPHY

Angels

The gradual incorporation of the information technology in the lives of citizens leads the city to get over the traditional constraints of space and gradually towards also overcoming the time-space issue, towards a form of communication that is completely angelic. This form of communication makes the space perfectly indifferent and homogeneous.

Earth

But the space takes revenge of this desire of ubiquitous! The man is enslaved by an insuperable psychological need of space that is at odds with that one of ubiquity. (M. Cacciari, in *La città*, Pazzini, 2004).

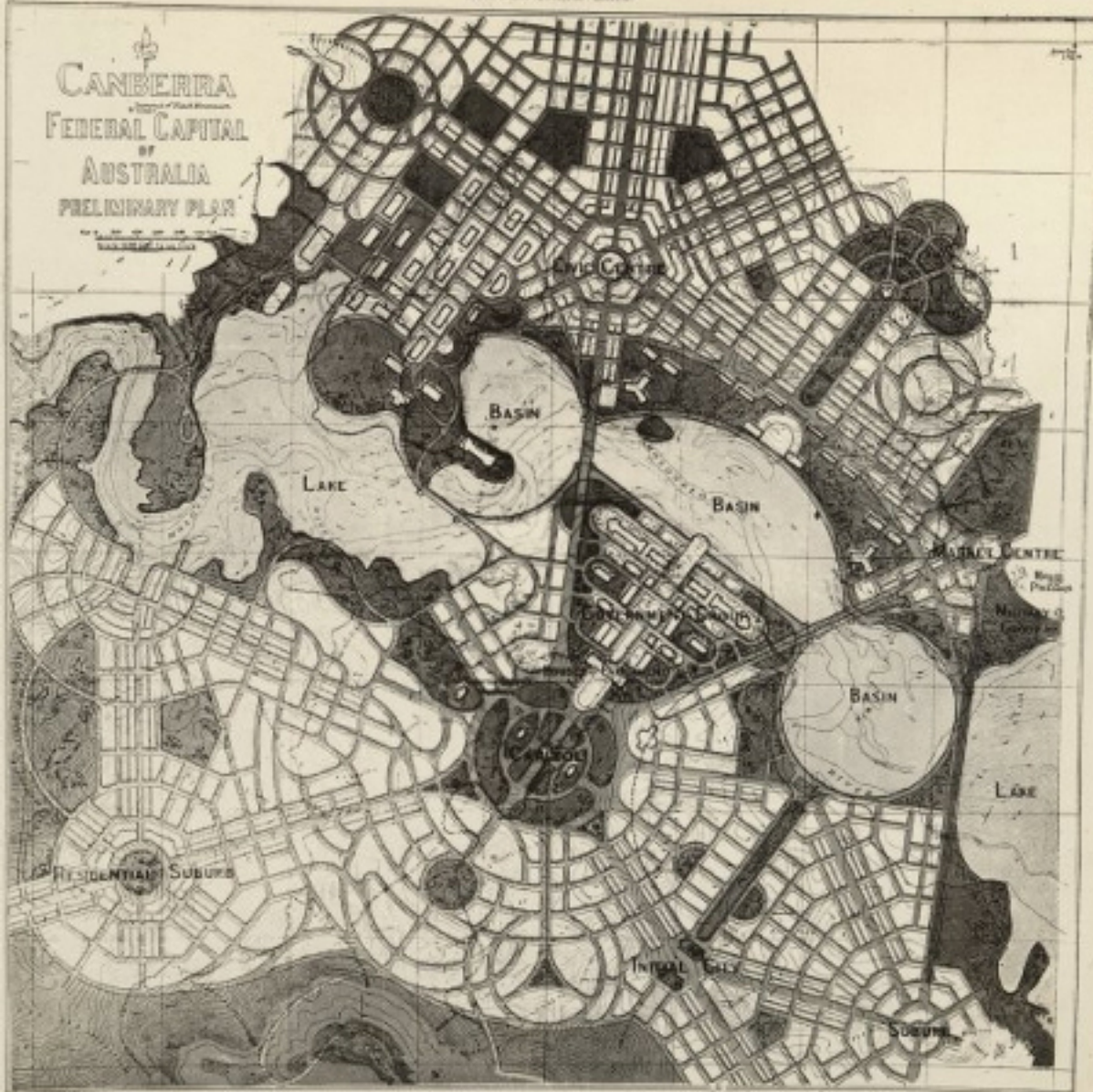

Canberra was founded a century ago by the strong desire to the model of government and way of life considered to be preferable in that historical context. Its macro-morphology is composed of extended and recognizable dimensions of Capital Hill / Vernon Circle enclosing the form of government and public life and the spread of the circulation/home/nature model of the garden city. One hundred years later, the new capital of Australia is facing new challenges. The logic of physical proximity and geographical convenience that regulated the "balanced" positioning in the capital (the battle of sites) are renewed by the forecasts of a future marked by several milestones of which the hypothetical scenario of the capital will seize the opportunity. Canberra stands as mediator between the city of angels and that one placed on the ground.

BOUNDARIES

hierarchy by space



proximity by scope

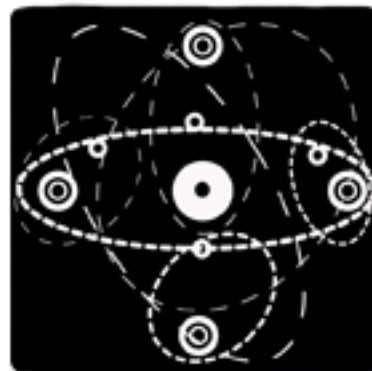

The traditional boundaries of nation vs nation, capital vs. suburbs, home vs. nature is crumbling. The new structure of the city is no longer governed by the rules of physical proximity, by the income of citizens or the hierarchy of functions, but is governed by the interconnected abilities both physical and intangible. The rule that dominates spatial relations is bound to the capacity of a "knowledge hub" in order to establish relations with another "knowledge hub" in an unlimited tangle that is a function of creativity and of ability to network.

BUILDINGS TECHNOLOGY

steel / concrete

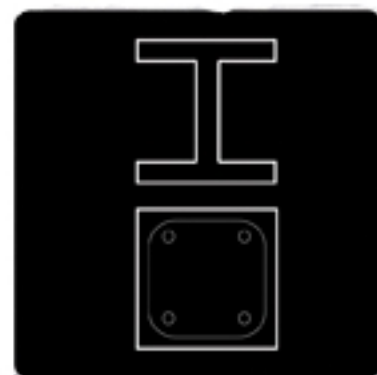

bio materials

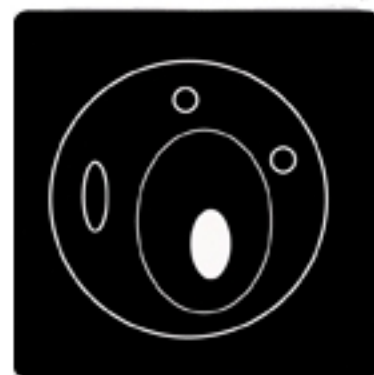

The overlap between the artificial building and natural element has become perfect. The buildings are no longer derived from the process of subtraction and manipulation of matter but are composed of natural organic materials and meet the metabolic cycle of nature thanks to increased discoveries in the field of nanotechnology and cyber-biology.

COMMUNICATION

dedicated spaces

all over / whenever

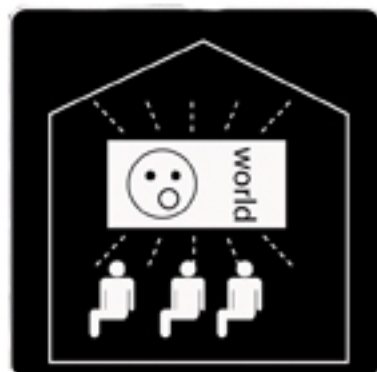

Communications technology has become pervasive and allowed to receive and share information, pictures and content with everyone and everywhere. Internet, social networks, smart-phones are a new dimension, in which there is no temporal distance, or space. The communication is all over and whenever. The knowledge, the decisions and the choices traveling in the immediacy and without misunderstandings.

CONTINENTAL SYSTEM



The capital city of Australia is the first nucleus of the generative development of a continental system which involved cities able to renew their paradigms. The multiple connections of New South Wales and ACT with the pacific context are developed in order to reconnect the system with the Asian development which is structured along the reverse route of Captain James Cook. The contractions of physical boundaries in favor of aims relationship allow to place the capital in the middle of the new continental dynamics. The limits defined by the Australian territory, such as deserts, oceans, languages and ethnic groups, are eliminated. The aim of the continental system is the social cohesion, the harmonious development of the territory according with its specific human and natural resources.

ENERGIES

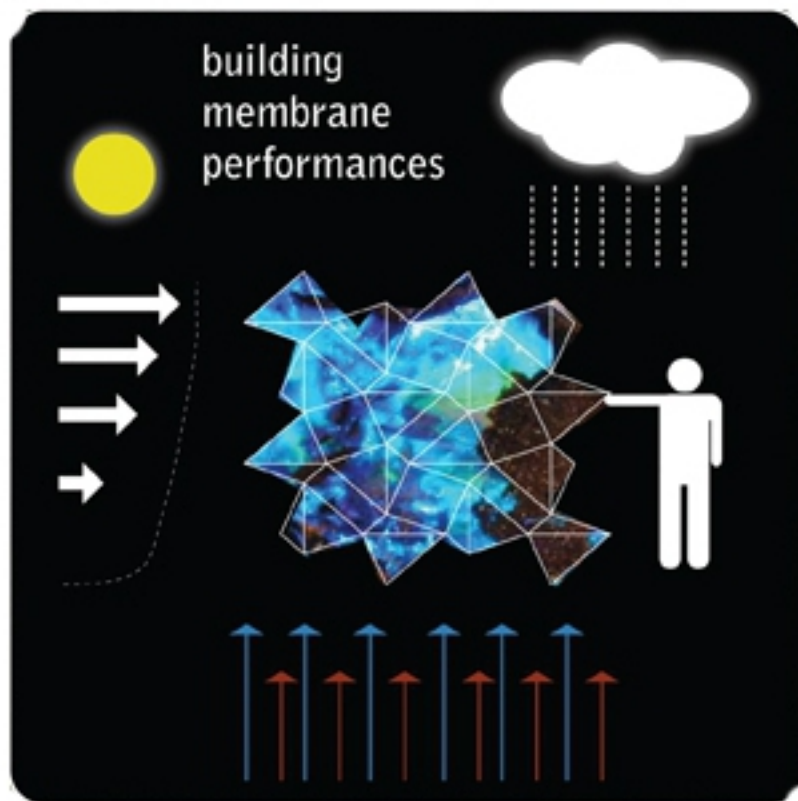

The power fossil sources are exhausted and the use of nuclear energy is abolished. Despite the rationalization of consumption, the city continues to need energy due to population growth, mobility, for industrial and individual use. Energy comes entirely from the exploitation of renewable sources and requires new forms of accumulation and exchange.

GLOBAL / LOCAL

asimmetric

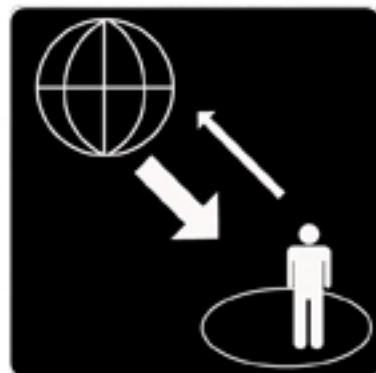

holistic

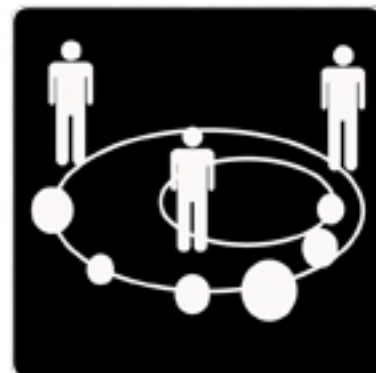

The awareness to live in a changing era and the comprehension of the main steps of the epoch-making "global rules", has allowed the new capital to drive change, without consequences for the citizens. The new Capital has become the heart of the Nation and an important reference on the world stage, especially for the quality of life of citizens, the ability of public management, the cultural and economic dynamism. It is a holistic model of urban living against the asymmetries generated by the distortion of the western capitalist model.









KNOT AND CORRIDORS

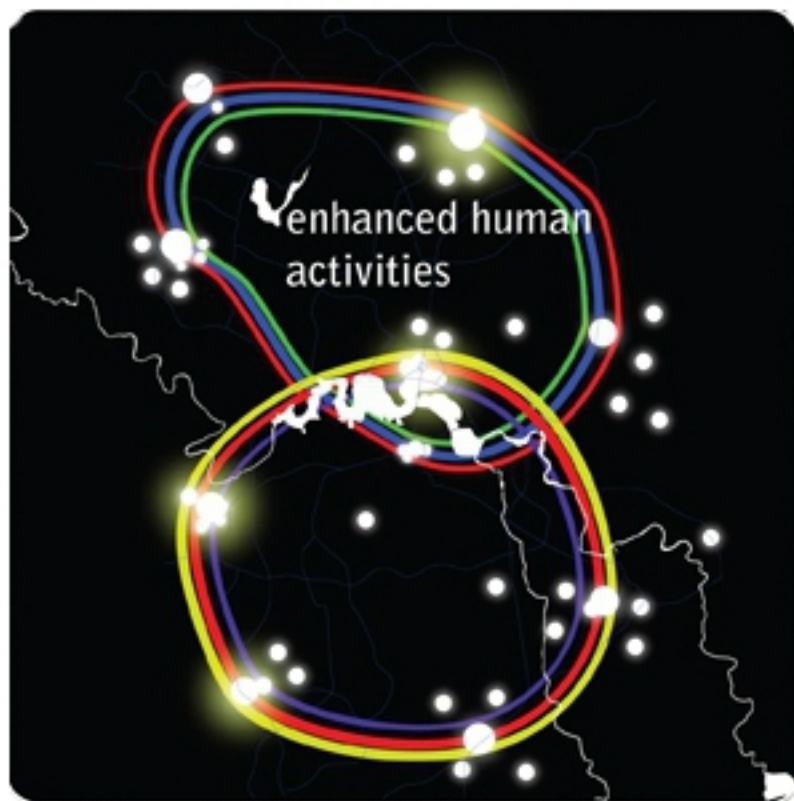

The knot of roads built around the Canberra city garden and the system of national air routes has assured the mobility around the traditional territory, but the conditions are changed. The mobility is not guarantee because the exponential increase in population and social complexity. The knots are now connected to a new system of individual/collective mobility able to perform many urban functions simultaneously.

LIVING FLOWS



The possible scenarios of the city are driven by the equilibrium of the metabolic flows that are generated inside: biotic flows, physical flows and intangible flows. The scenario changes for the purposes of development of human resources through the harmony of natural and physical size which take place through the mediation of technology, according to the following key processes: growth of human resources; equity to humans and animals; Biotic productivity, or growth of production of primary industry; abatement of pressure on the load capacity of the territory (due to population growth, income growth, emissions, climate change); control of the transformation process in its entire cycle, from concept to management.

MOBILITY

move objects



move minds

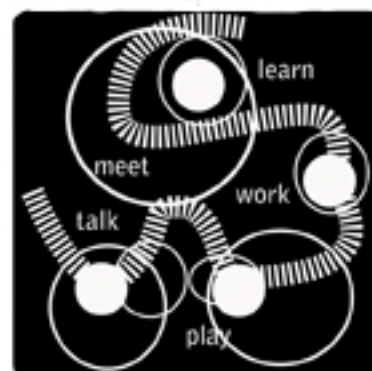

The mobility of the body is a need that remains and is made along the neuronal flow. It is able - like the building that looks like more and more - to perform other public duties in the absence of negative externalities. The super-road is a place to recognize and drive the people who attend it to become a media infrastructure, as well as sidewalk, square and a shop. Individual mobility is ensured by systems that can interact with the environment in a whole new way.

NATURE

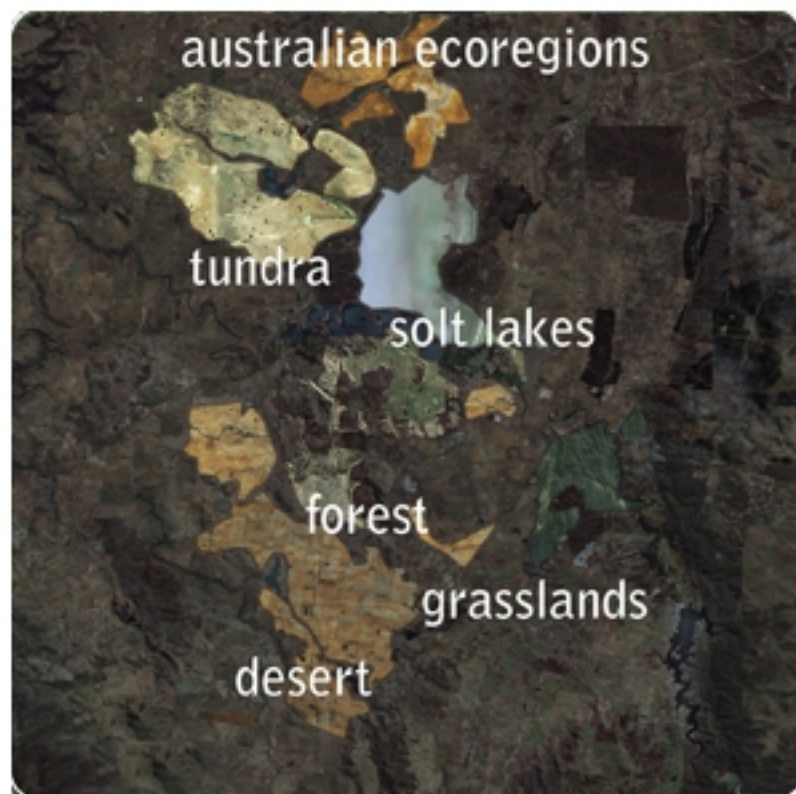

Due to the dramatic climate change the natural Australian ecosystems advance within the settlement of Canberra of the twentieth century, creating a new balance between man and nature. The nature is no longer a resource to be used indefinitely, but it becomes a rare resource. The question of the preservation of natural elements is essential in the planning of the capital city. It promotes the concentration of human activities and the limit between city and nature is removed. It convert the natural protected asset into productive asset, able to power both economy and production.

SHARED PLATFORMS



The flows of knowledge have enhanced the ability of citizens to move from a model based on a local versus a global one to a model based on global connectivity and local integration. The shared platforms allow to continuously monitor the changing dynamics of the city: the inhabitants and their preferences, the environment and resources, allowing to increase the knowledge and free the creativity.

SHELLS

walls resistance

membrane resilient

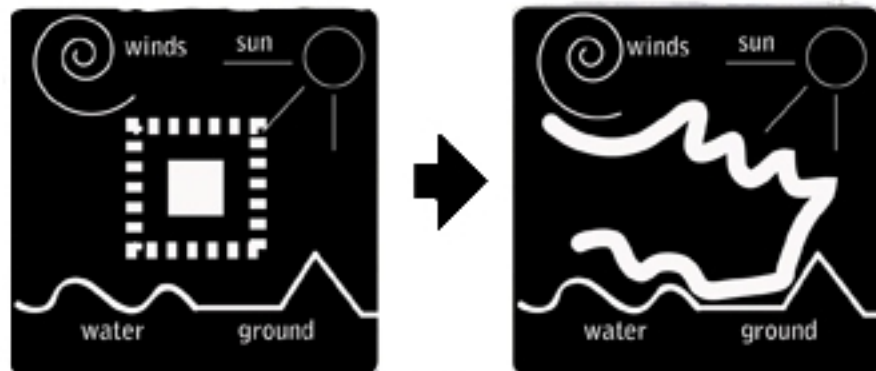

The building shell, initially a barrier to isolate the man from nature, has become a resilient and interactive membrane. The passive structures of the city become intelligent: they produce energy, acknowledge, through sensors, both the individual and natural preferences. The smart building with a nervous system is able to understand the interactions with the ecosystem of which it forms an integral part.

SHELTER

in / out

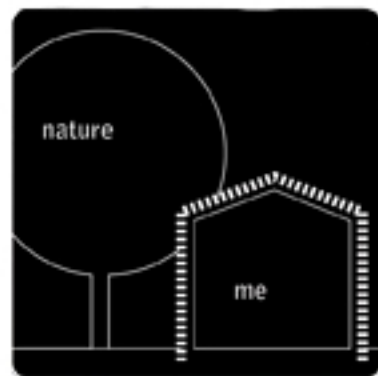

body machine



As a result of the diffusion of nanotechnology, the membrane lining the building has also been applied on and under the skin of man, contributing to the development of the body as a machine communication. The traditional need for a shelter from the elements is replaced by an enhanced "sensory abilities", dropping the spacial constraints and enhancing the creative possibilities of the human brain.

TYPES

city tree

+

city tower

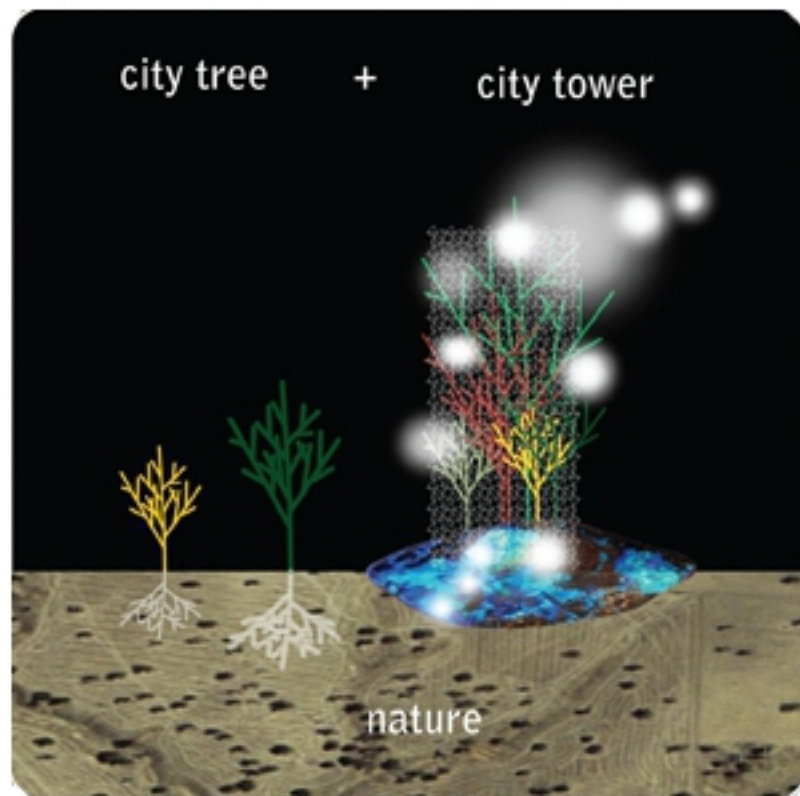

URBAN FUNCTIONS

boring / alone

creative / together

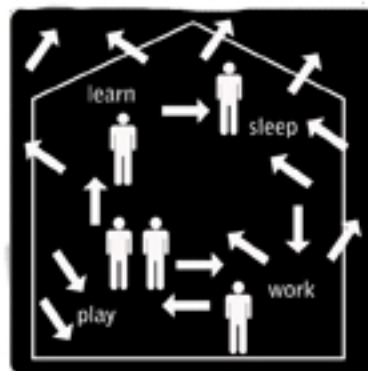
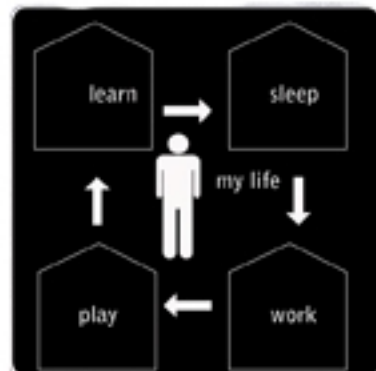

All the city's activities take place in cyberspace disappearing traditional urban functions located in dedicated places. Today, places such as buildings, squares, streets meet the need for intimate physical and real contact, but they lose their functional roles. Everyone works together in a creative environment.

WHAT'S NEXT **CANBERRA**

Canberra becomes the city where the streets are not only infrastructure for the movement of bodies, but the streets, as well as buildings and squares are also virtual roads useful for the movement of ideas. Canberra is also the city of angels. Canberra is ANGELOPOLIS.

WHAT'S NEXT **SPACE**

NEW BOUNDARIES

The visions of the Australian capital cities depend on the new physical limitations caused by the changing of the city's values. The changes affect the composition of the social structure, the relations of proximity, infrastructure assets, the capabilities of the physical mobility, the relations between the built space and natural space.

WHAT'NEXT? TIME

NEW GLOBAL PARADIGMS

Thinking to the renewal of the Australian Capital does not mean to think to the renewal of physical assets, but it means updating the values which underpin the community. Therefore, we propose an urban model founded on the concept of manipulation of time, in opposition to the classic urban model founded on the concept of manipulation of the space, through the articulation of foreseeable future that drive and shape the scenarios of the Australian capital. The world is undergoing dramatic changes, which occur at a rate never seen before, that leave their mark on the continents, countries and cities. The recognition of the challenges of the future have led to the creation of new capital, as a guide for a renewed pact of coexistence among citizens.

WORK / LIFESTYLE

specialization / split

self / environment

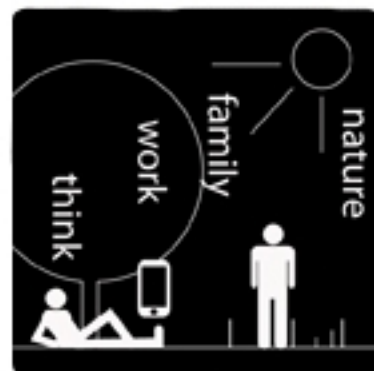
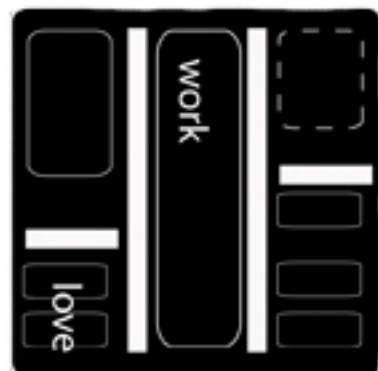

The growth speed of information and the desire of ubiquitous modifying the lifestyle of people and the shape of cities. Two worlds are added together: the real world, or physical space, which is inhabited by bodies, and the virtual world, or cyberspace, inhabited by ideas. The working world, the spare time, the mobility take place wherever. The external environment is the place where carry out the social functions.

WORLD DYNAMICS



The radical increase in world population, the effects of climate change and the spread of conflicts cause the mobility of millions of people around the world in search of better conditions. Canberra arises its inhabitants from 300.000 to 3.000.000. The updated roles of space face the shift from endless territory (sub/urban sprawl) to harmonious development according to natural rules.